



DS-CR14-01

KIT COLLEGAMENTO CON ROSONI

Connection set with wall plates

ART. 0031	Prolunga di collegamento tra raccordo a muro da 1/2" e valvola radiatore, con tubo saldato \varnothing 15 mm. <i>Extension to connect the 1/2" wall fitting to the radiator valve, with \varnothing 15 mm welded pipe.</i>
ART. A491	Kit di collegamento con rosoni tondi (2 pezzi), \varnothing 15 mm, lunghezza 150 mm x 1/2" <i>Round connection set (2 pcs), \varnothing 15 mm, length 150 mm x 1/2"</i>
ART. A492	Kit di collegamento con rosoni quadri (2 pezzi), \varnothing 15 mm, lunghezza 150 mm x 1/2" <i>Square connection set (2 pcs), \varnothing 15 mm, length 150 mm x 1/2"</i>
ART. A493	Kit di collegamento per mono/bitubo interasse 38 mm; \varnothing 15 mm, lunghezza 150 mm x 1/2". <i>Connection set for one/two pipe system radiator valves with 38 mm centre distance; \varnothing 15 mm, length 150 mm x 1/2"</i>
ART. A494	Kit di collegamento per gruppi 50 mm; \varnothing 15 mm, lunghezza 150 mm x 1/2". <i>Connection set for radiator valves with 50 mm center distance; \varnothing 15 mm, length 150 mm x 1/2"</i>
ART. A497	Kit di collegamento tondo floreale (2 pezzi), \varnothing 15 mm, lunghezza 150 mm x 1/2". <i>Round floral connection set (2 pcs), \varnothing 15 mm, length 150 mm x 1/2"</i>



0031



A491



A492



A493



A494



A497

MATERIALI E CARATTERISTICHE TECNICHE

Rosone	Ottone trafilato: CW614N - UNI EN 12164
Raccordo	
Rosone (solo per art. 0497)	Ottone stampato: CW617N - UNI EN 12165
Tubo	Ottone: CW508L - UNI EN 12449
O-Ring	Gomma EPDM PEROX

MATERIALS AND TECHNICAL FEATURES

Wall plate	Extruded brass: CW614N UNI EN 12164
Connection	
Wall plate (only for art. 0497)	Pressed brass: CW617N UNI EN 12165
Tube	Brass: CW508L - UNI EN 12449
O-Ring	EPDM PEROX rubber

Disegni Drawings

0031

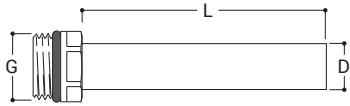

G	L	D
1/2"	150	15

A491

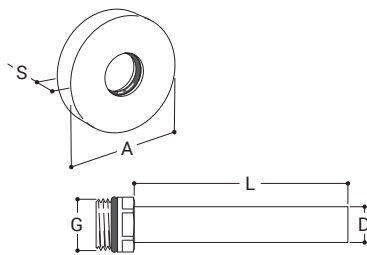

G	D	L	A	S
1/2"	15	150	50	12

A492

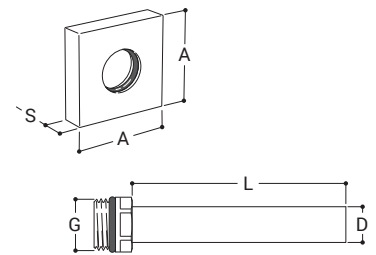

G	D	L	A	S
1/2"	15	150	40	12

A493

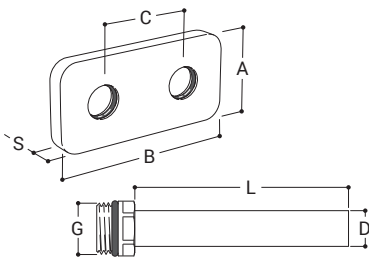

G	D	L	A	B	C	S
1/2"	15	150	50	88	38	12

A494

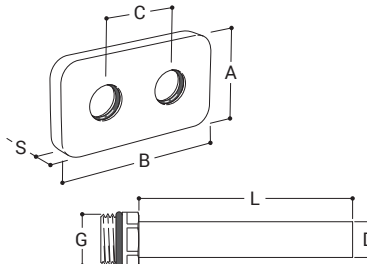

G	D	L	A	B	C	S
1/2"	15	150	50	100	50	12

A497

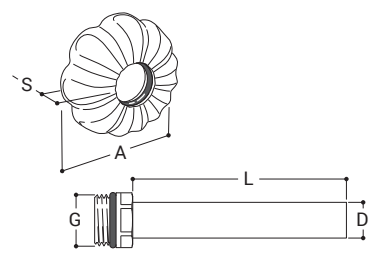

G	D	L	A	S
1/2"	15	150	51	15

